

1964 CLASSROOM *Renovations* AND MORE...



LANCASTER MENNONITE **BRIDGES TO THE FUTURE** CAMPAIGN



A MESSAGE FROM OUR SUPERINTENDENT



Dear Alumni, Parents and Friends,

Lancaster Mennonite School is embarking on exciting new times. One of LM's strengths is facilities that are conducive to learning. This speaks to our community that values a healthy and positive, innovative learning environment for students. It is an expectation of families and standard set by the board of directors and administration for excellence.

The 1964 Classroom Building houses several of our core subject areas; English, Bible, and Social Studies, and needs updating. The original portion of the building most often referred to as the '64 Wing, still has the original finishes and colors, and lacks air conditioning. While no air conditioning has been a character building opportunity for 55 years, it's time to upgrade and improve the learning environment.

LM received matching gifts of a million dollars that will help us reach our goal for renovating the 1964 Wing, but we still need your help.



In addition to the 1964 Classroom Renovation, this campaign is an opportunity to secure the future of LM by eliminating debt and securing scholarships. LM seeks to be fiscally responsible by reducing debt that will ease tuition increases and securing scholarships, making LM accessible to a socioeconomically diverse student body.



THIS CAMPAIGN BUILDS ON THE ROCK THAT WAS STARTED IN 1942.

Jesus said,
Build Your House on the Rock:

24 "Therefore everyone who hears these words of mine and puts them into practice is like a wise man who built his house on the rock. 25 The rain came down, the streams rose, and the winds blew and beat against that house; yet it did not fall, because it had its foundation on the rock.

Matthew 7:24-25

Sincerely,

Dr. Pamela Tieszen, Superintendent

Current Number
of Students

(Includes all 3 campuses)

847

Programs

"I chose LM because I wanted to surround myself in a Christian environment, and with teachers that genuinely care about the students."

- Chloe King '19



28 Honors &
AP Classes

for students to choose from



"LM has prepared me for the future! I am trusting God's plan and pursuing my passions - music education and theatre - in college next year!"

- Javon Thomas '19

Students from **6 STATES**
and **15 COUNTRIES**

Excellence
201 Church
Congregations
Represented

SAT scores are consistently

140 POINTS

above the **NATIONAL AVERAGE**

*"People at
LM don't just
preach the
word, they
live it."*

- Ty Bair '95

- Carrie Bair '94



3 CAMPUSES:

- Lancaster
Grades 6-12
- Locust Grove
Grades PreK-8
- New Danville
Grades PreK-5

Community

A perspective view of a long, empty school hallway. On both sides are rows of green metal lockers. The floor is a polished, light-colored material that reflects the overhead fluorescent lights, creating a series of bright, repeating reflections down the center of the corridor. At the far end of the hallway, a sign is visible above a doorway, which reads "WALTER HENNONITE". The walls are a neutral, light color, and the overall atmosphere is quiet and institutional.

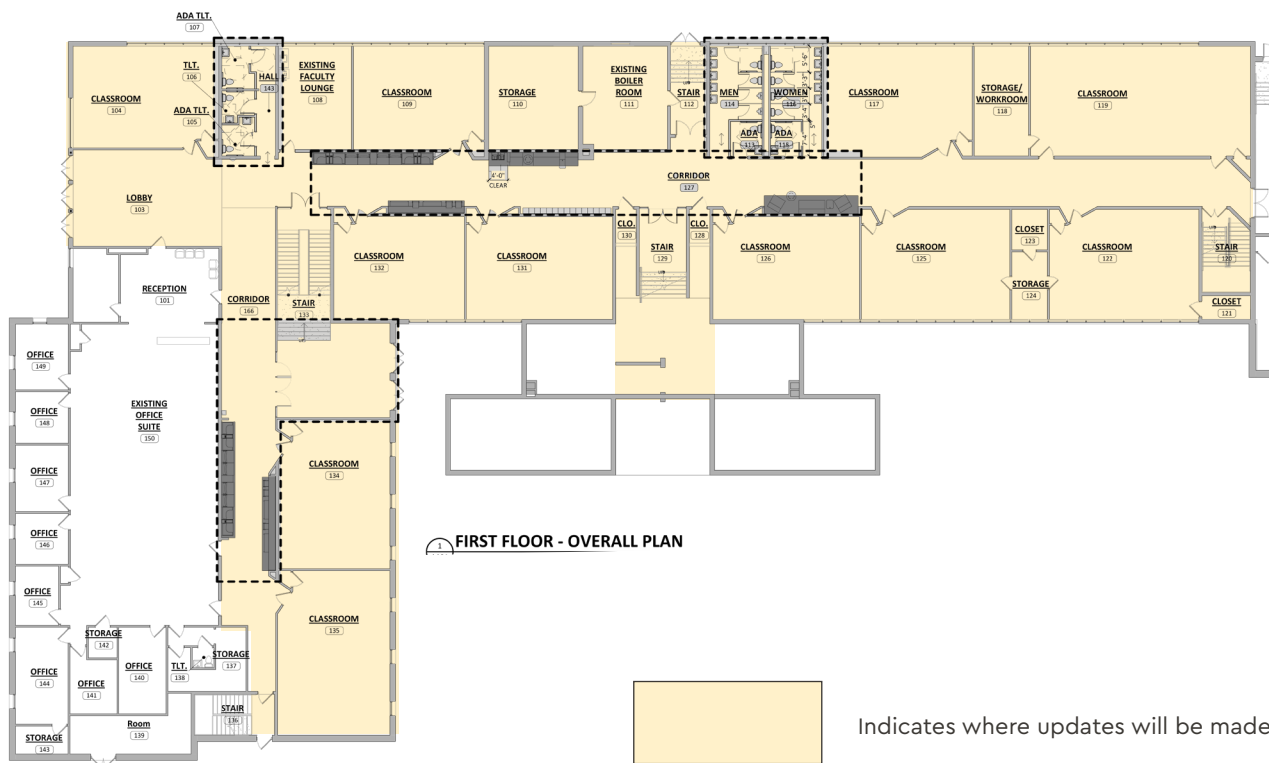

A LOOK AT THE NEW



**Disclaimer: Artist rendering. Final outcome may differ.*

New gates and exterior
fencing for security.

 Indicates where new
gates will be located.

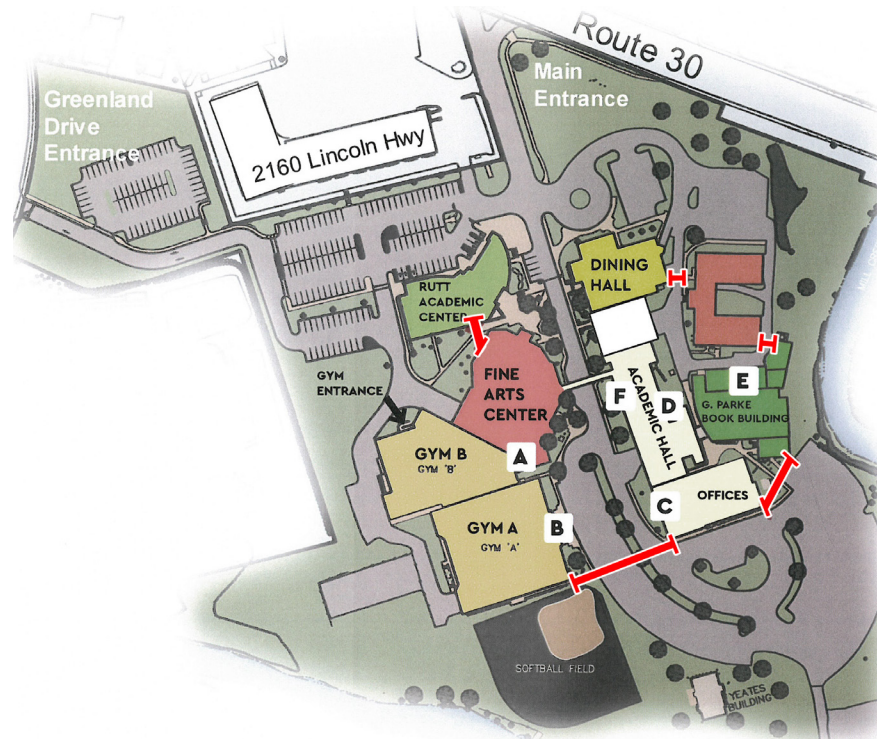



HOW YOU CAN HELP

- **HELP FUND RENOVATIONS**
- **HELP PAY DOWN DEBT LOAD**
- **HELP FUND STUDENT SCHOLARSHIPS**

GOAL: \$6 MILLION

\$2M - '64 Wing Classroom Renovations

We want to create a safe and healthy learning environment in the 1964 classrooms with new heating and air conditioning installation, secure entry to student areas, and refurbishment of classrooms. This includes ceilings, flooring, lights, electrical, data lines, bathrooms, and window treatments.

\$2M - Pay Down Debt Load

Over the past decades LM has accumulated \$8 million in debt. Some of this is due to unpaid commitments, and some due to unfunded projects. Join us in removing this expense from LM operations, and make tuition more affordable.

\$2M - Student Scholarships

Join us in supporting students who want a Christ-centered education but do not have the resources to afford full tuition. Give to the student aid fund, start a named endowment scholarship and/or participate in the Pennsylvania scholarship tax credit.

BRIDGES
to the
FUTURE



JOIN US TO GROW MORE WORLD CHANGERS!

Your support will help us create a safe, creative learning experience that challenges students to look beyond themselves and grow their faith.

Join us in supporting LM students by pledging your commitment today! >>>



Yes! I/We want to support Lancaster Mennonite Students.

I/We commit _____ in total.

2020		2021		2022		TOTAL
\$ _____	+	\$ _____	+	\$ _____	=	\$ _____

Please direct my/our gift to (please check desired giving category)

- ☐ Annual Fund
 ☐ '64 Renovations
 ☐ Student Aid
 ☐ Pay Off Debt
 ☐ Other _____

Type of gift:

- ☐ Cash
 ☐ Stock
 ☐ Real Estate
 ☐ Other Assets (please describe): _____

- ☐ I/We have included LM in our estate plan.
 ☐ I/We prefer an annual commitment notice.

Name _____

Address _____

Telephone _____ Email _____

Signature _____ Date _____



**LANCASTER
MENNONITE**
LANCASTER CAMPUS

lancastermennonite.org/1964classroom

Please make your check payable to Lancaster Mennonite School and mail to: 2176 Lincoln Highway East, Lancaster, PA 17602.

All gifts will be receipted and are tax-deductible. If you have questions, please contact the Advancement Department, at 717-509-4459.

Thank you for your contribution to transforming lives through excellent, well-rounded PreK-12 education in a nurturing and Christ-centered environment.